



SAW Components
Data Sheet
CQTSF1270M00.00

Customer's Approval Certificate	
Complies with Directive 2002/95/EC (RoHS)	
Please return this Page Via email as a certification of Your approval	
Checked & Approval by:	Date:

Hangzhou Freq-control Electronics Technology Co.,Ltd.

TEL:0086-571-85803723

FAX:0086-571-85803724

sales@csimc-freqcontrol.com

Features

- Low-loss RF filter for mobile systems
- Low amplitude ripple
- No matching network required for operation at 50Ω
- Ceramic package for **Surface Mounted Technology (SMT)**
- Lead-free production and **RoHS** compliant

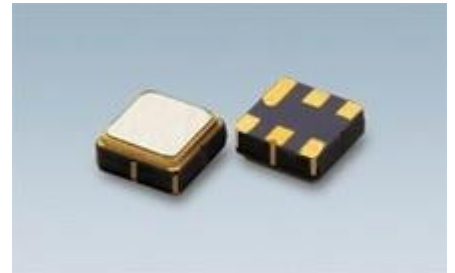

Package Dimensions

Ceramic Package: **DCC6C**

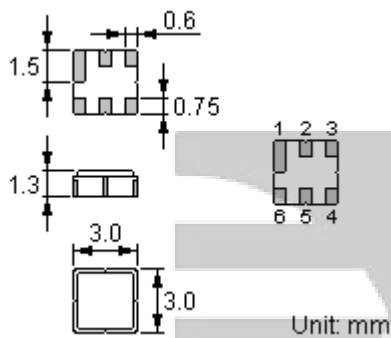

Pin Configuration

2	Input
5	Output
1, 3, 4, 6	Ground

Maximum Ratings

Rating		Value	Unit
Input Power Level	P	10	dBm
DC Voltage	V_{DC}	0	V
Operating Temperature Range	T_A	-40 ~ +85	°C
Storage Temperature Range	T_{stg}	-40 ~ +85	°C

CHINA QUARTZ TECHNOLOGY

Electrical Characteristics

Item		Minimum	Typical	Maximum	Unit
Center Frequency	f_c		1270		MHz
Insertion Loss	IL				
	1268.00 1271.00 MHz	--	2.5	3.0	dB
Group Delay Ripple	1268.00 1271.00 MHz		5	30	ns
Absolute Attenuation	α				
	0.30 1240.00 MHz	40	48		dB
	1300.00 1500.00 MHz	40	48		dB
	1500.00 2000.00 MHz	35	40		dB
	2000.00 3000.00 MHz	30	37		dB
Consistent of multi-phase devices				8	deg
Phase nonlinear ripple	1268.00 1271.00 MHz	$\Delta \alpha$	2**	5 *) *(deg
Amplitude Ripple (p-p)	1268.00 1271.00 MHz	$\Delta \alpha$	0.3**	0.5 *) *(dB
Input VSWR	1268.00 1271.00 MHz		1.5 ; 1	2.0 : 1	
Output VSWR	1268.00 1271.00 MHz		1.5 ; 1	2.0 : 1	
Input / Output Impedance (Nominal)			50		Ω

RoHS Compliant *): -40°C ** : +25°C *(: +85°C Electrostatic Sensitive Device

Typical Frequency Response

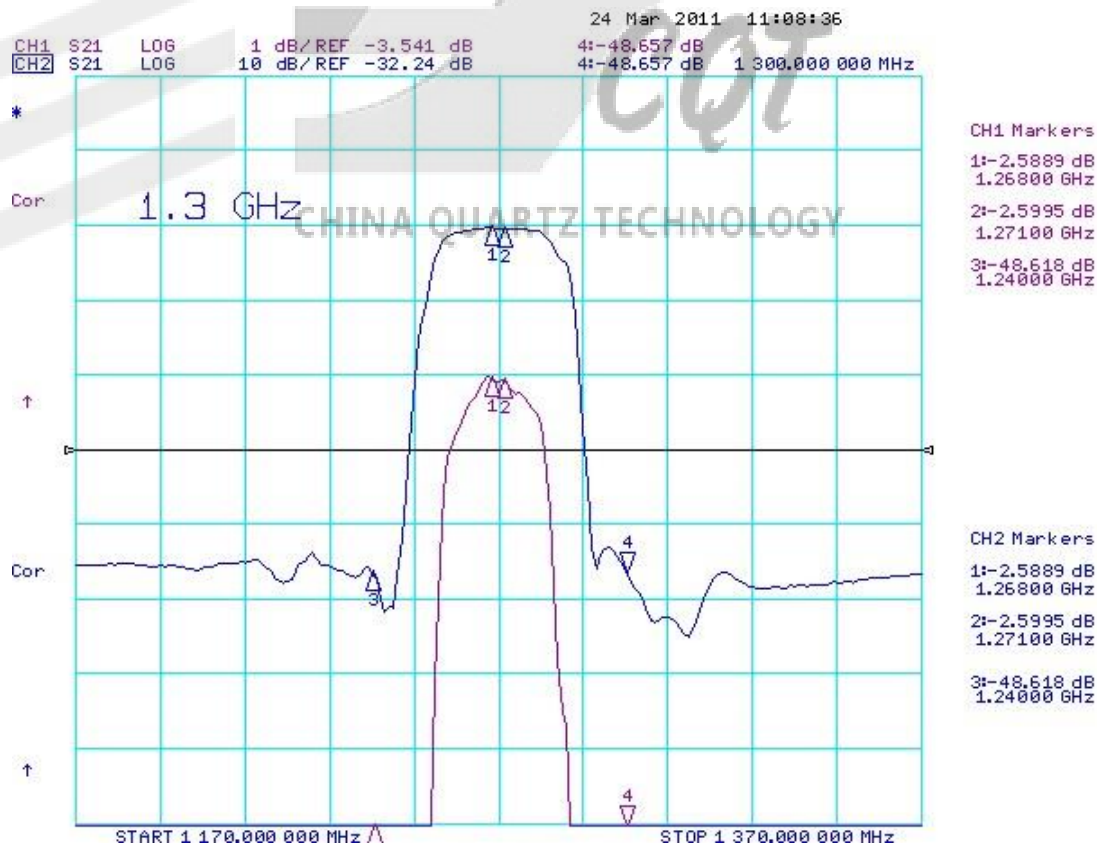

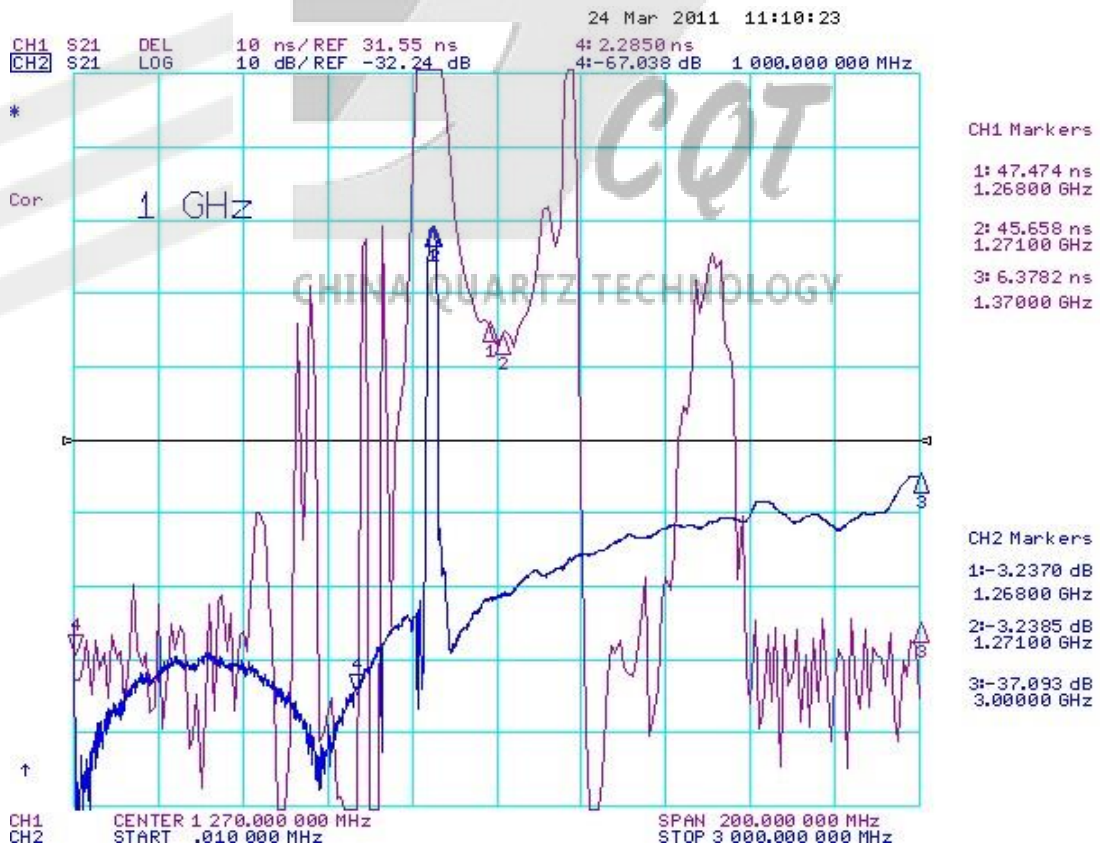
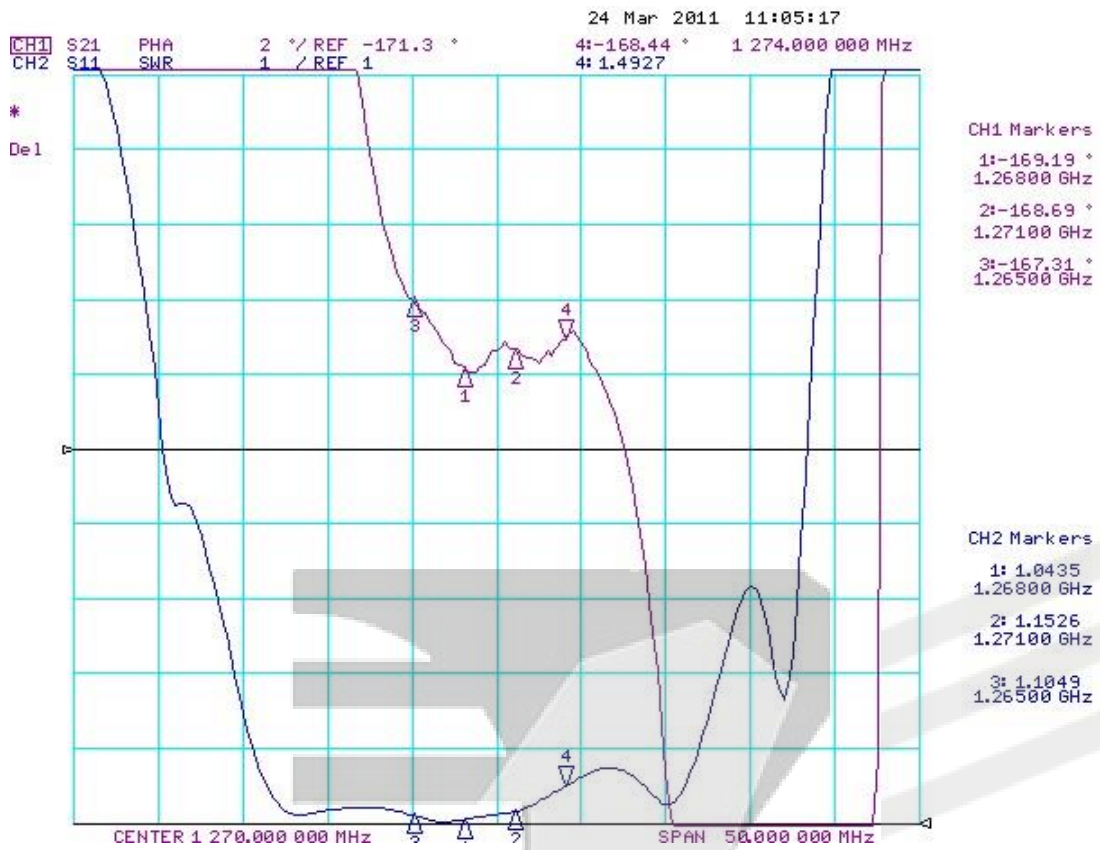

Stability Characteristics

	Test item	Condition of test
1	Mechanical shock	(a) Drops: 3 times on concrete floor (b) Height: 1.0 m
2	Vibration resistance	(a) Frequency of vibration: 10~55Hz (b) Amplitude: 1.5 mm (c) Directions: X,Y and Z (d) Duration: 2 hours
3	Moisture resistance	(a) Condition: 40°C, 90~95% R.H. (b) Duration: 96 hours (c) Wait 4 hours before measurement
4	Climatic sequence	(a) +70°C for 16 hours (b) +55°C for 24 hours, 90~95% R.H. (c) -25°C for 2 hours (d) +40°C for 24 hours, 90~95% R.H. (e) Wait 4 hours before measurement
5	High temperature exposure	(a) Temperature: 70°C (b) Duration: 250 hours (c) Wait 4 hours before measurement
6	Thermal impact	(a) +70°C for 30 minutes ⇒ -25°C for 30 minutes repeated 3 times (b) Wait 4 hours before measurement

Requirements: The SAW filter shall remain within the electrical specifications after tests.

Remarks

- SAW devices should not be used in any type of fluid such as water, oil, organic solvent, etc.
- Be certain not to apply voltage exceeding the rated voltage of components.
- Do not operate outside the recommended operating temperature range of components.
- Sudden change of temperature shall be avoided, deterioration of the characteristics can occur.
- Be careful of soldering temperature and duration of components when soldering.
- Do not place soldering iron on the body of components.
- Be careful not to subject the terminals or leads of components to excessive force.
- SAW devices are electrostatic sensitive. Please avoid static voltage during operation and storage.
- Ultrasonic cleaning shall be avoided. Ultrasonic vibration may cause destruction of components.

CHINA QUARTZ TECHNOLOGY

Test Circuit

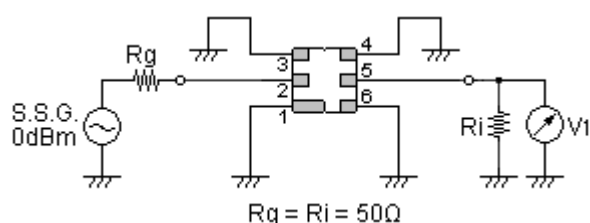

Recommended Land Pattern

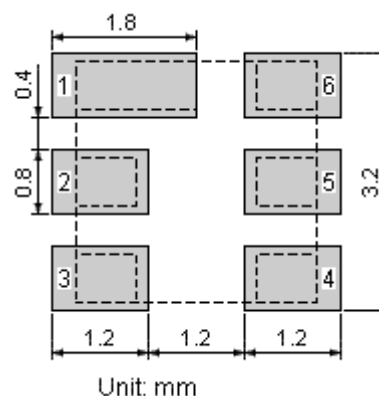

Packing Information

Carrier Tape

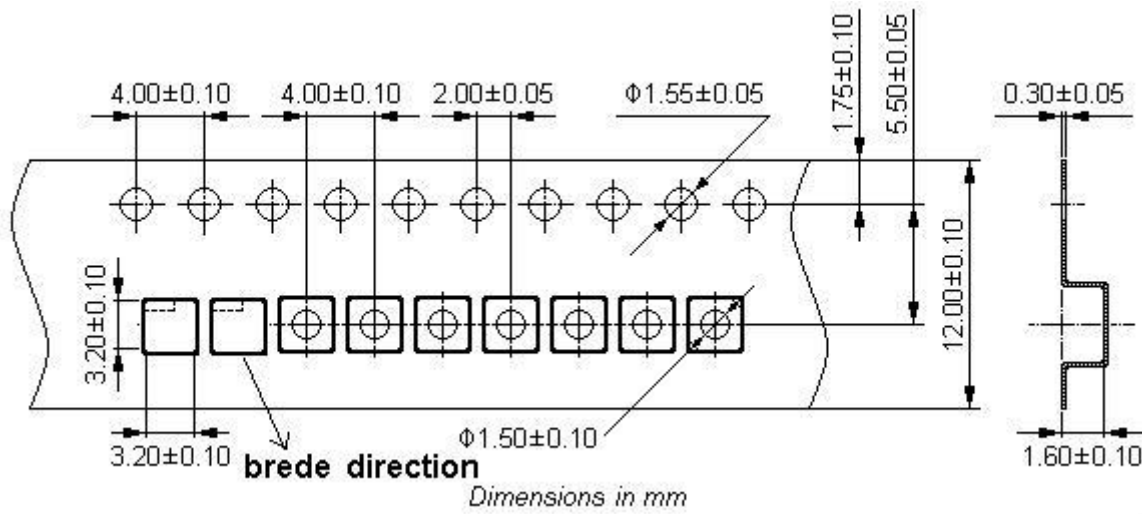

Reel Dimensions

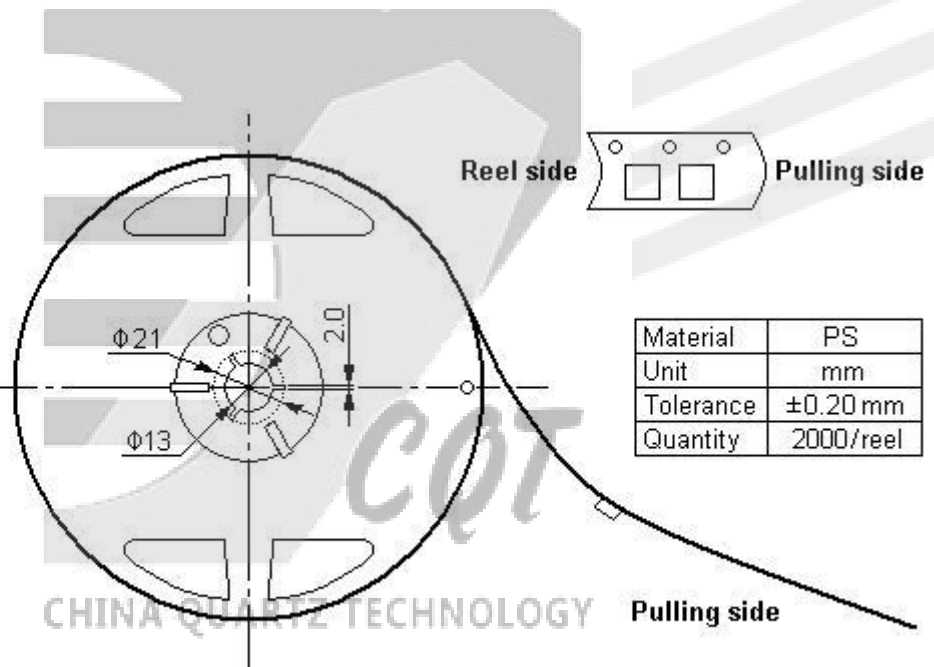
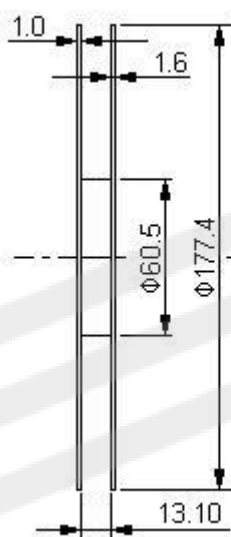

Material	PS
Unit	mm
Tolerance	±0.20 mm
Quantity	2000/reel

Outer Packing

Type	Quantity	Dimension	Description	Weight
Carton Box I	10000	190×190×95	anti-static plastic bag & carton box	0.85
Carton Box II	20000	190×190×190	1 reel / bag 5 bags / box (10000 pcs) 10 bags / box (20000 pcs)	1.80

Unit: mm Unit: kg

Recommended Soldering Profile

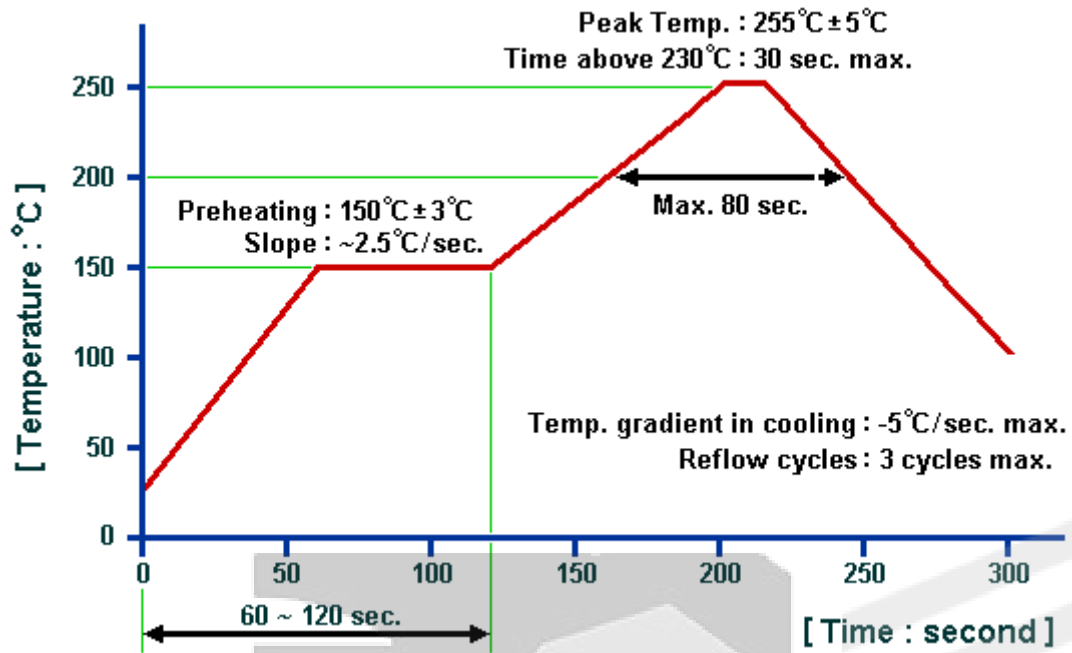

CQT
CHINA QUARTZ TECHNOLOGY